

注意！こちらの製品は正規品ではありません。
XENAJAPAN の保証対象外となります。

XENA
INTELLIGENT SECURITY



USER MANUAL for
XX14
Alarmed Disc-Locks

www.xenasecurity.com

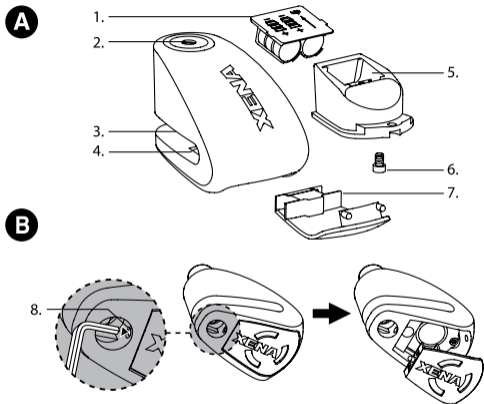

*For more product details, please check with your local XENA dealer or visit www.xenasecurity.com

Fitting **XENA** to your motorcycle's brake disc

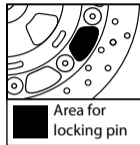

1. Thickness of brake-disc: Standard issue on virtually all motorcycle models at just under 7mm (1/4")
2. Locking-pin size: 14mm (1/2").
3. Distance from locking-pin to back of disc-slot*: 41mm (1 1 5/8")

*Note that the locking pin can pass through ANY hole on the brake disc (see dark area on diagram).

Parts of XX14 Alarmed Disc-Lock (A)

- | | | |
|-----------------|-----------------|----------------|
| 1. Battery pack | 4. Reflector | 7. Lid |
| 2. Lock barrel | 5. Alarm module | 8. Release pin |
| 3. Locking pin | 6. Screw | |

The Locking System

- Insert key and rotate clockwise. Lock barrel will spring open.
- Place on motorcycle's brake disc.
- Locate gap in brake disc that will allow locking pin to pass through.
- Push lock barrel down to insert locking pin until it clicks shut.

For more information on fitting XENA to your bike, go to www.xenasecurity.com/faqs.

The Alarm System

- Your XENA alarmed disc-lock is self-arming. It will activate within approximately 5 seconds of being locked onto your brake disc.
- There is no on-off switch. The unit automatically senses the presence of your brake disc.
- Once in place, the alarm will beep once to confirm that it is armed.
- Once armed, shock & motion sensors work independently to determine if your bike is being tampered with.
- Once triggered, the unit will emit five countdown beeps, and alarm will sound for 10-15 seconds.
- If attack continues, the alarm will continue. If attack stops, the unit will re-set itself.

Replacing the Batteries

- Locate spring-loaded pin inside double-locking port on underside of lock; push in to release and remove module cover (Note: the release pin is hidden and totally inaccessible when unit is locked on a brake disc).
- Using hexagonal key provided, unscrew retaining screw and remove alarm module.
- Replace batteries. The unit will emit one beep to confirm that the battery pack has been installed correctly.
- Screw module back in place and replace cover plate.
- Use XBP-4 battery pack, available from all authorised XENA dealers, or 6 x LR44 button-cell generic batteries.

Battery Life

- Under normal use, batteries should last 8 months. Frequent triggering, or extreme temperatures can adversely affect battery life.
- Constant ticking or noticeable deterioration in alarm sound quality indicate that batteries are low.
- Low batteries affect performance. Replace batteries at first sign of low power.

Keys

- Each lock comes with three keys and a key tag with serial number (ie, X123456). Use this unique identification number to order more keys for your lock; the key tag should be stored separately; to order additional keys XENA requires the keytag along with owner details (including name, address and telephone number) and a receipt for the purchase of the lock. Keys will only be sent to the owner's address.

Caring for Your Lock

- Use a dry cloth to keep the LED reflector plate inside the disc-slot clean and free of dirt, dust, grease and grime. An obstructed reflector plate can adversely affect performance.

If Alarm Module Becomes Damaged

- Note: The self-contained alarm module can be replaced with a new unit from your local authorised XENA dealer.

- Note: the lock will continue to function as an effective anti-theft device, with or without the alarm system.

Taking Your XENA with You

- Ideally, carry your XENA underneath the seat of your bike.
- CAUTION: Do not carry your XENA in or attach it to your clothing, as this can cause serious personal injury in the event of an accident.

Troubleshooting

Alarm not arming: Move to different location on disc or replace batteries.

Lock making constant clicking or beeping sound, replace batteries.

Alarm too sensitive: Place at 6 o'clock on disk.

Alarm not sensitive enough: Place at 12 o'clock to 3 o'clock on disc.

Alarm doesn't disarm: Clean sensor and reflector.

FOR CUSTOMER CARE

Email us at: info@xenasecurity.com

DISCLAIMER:

XENA SECURITY ASSUMES NO RESPONSIBILITY OR LIABILITY FOR DAMAGES OR INJURIES RESULTING FROM THE MISUSE OF OUR PRODUCTS.